

HomeGuard® Cladding Detail

Example Only

Cladding Examples, Mini Orb®, James Hardie™ products or Weathertex™

- Top of slab to be cleaned, scrape off concrete imperfections and sweep surface.
- Mark where frame will be located with a chalk line using something like a Stanley Blue Chalk Line.
- Apply an approved adhesive to the substrate where the HomeGuard® Termite Management System will be positioned.
- Position HomeGuard® Termite Management System and secure with a clout or gas fired nail – no less than one metre intervals. Ensure to cover all nail heads with an HomeGuard® Termiflex.
- Ensure the correct sized cut of HomeGuard® is used to achieve the set minimum of 20 mm to extend below the cladding (*Communicate this requirement with the builder/client*).
- Speak to the contractor to ensure the cladding is firm against the HomeGuard® Termite Management System.

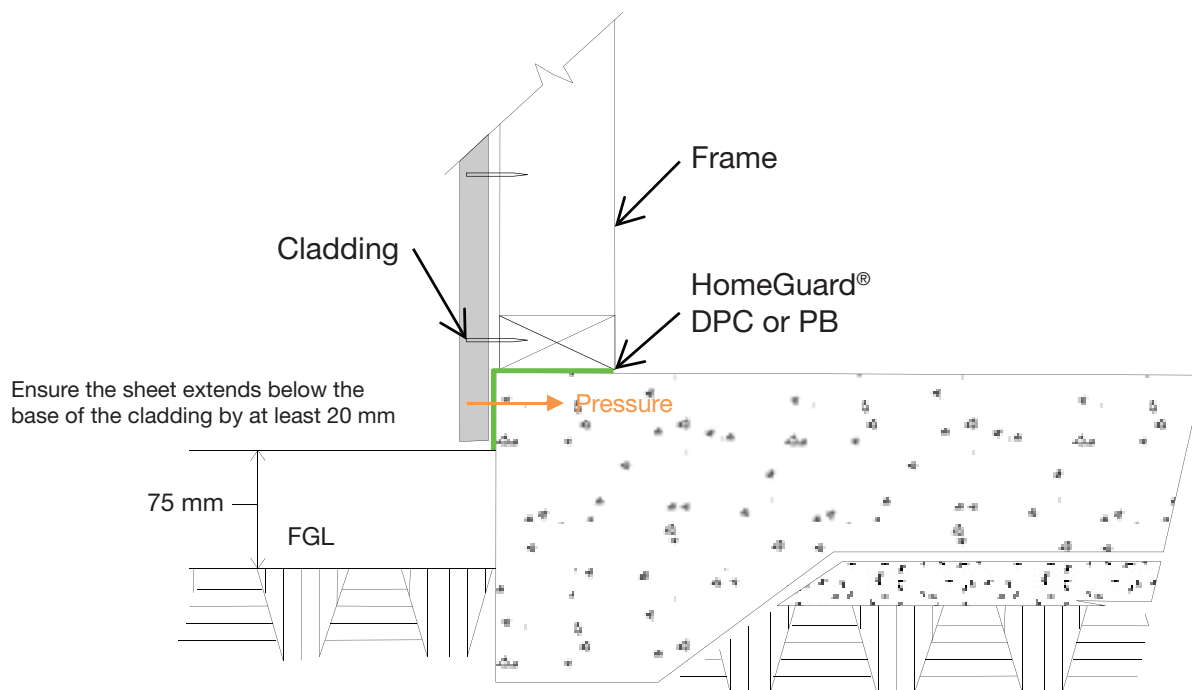

Certified



Manufactured in Australia

Please always refer to the HomeGuard® Installation Manual for further information