

Paths and Additions

For existing masonry to new concrete joints – including additions, paths, etc

External Perimeter Detail – Paths

- Ensure substrate surface is fit for installation ie smooth even and all imperfections have been addressed.
- Using appropriate filler, fill mortar joints and uneven surfaces for a vertical distance of 25 mm and within 20 mm of the upper edge of the new concrete.
- Fix one edge of the HomeGuard® TMB or PB sheet to the existing vertical edge surface using an approved adhesive or shooting gas fired nails at 1 M intervals (nails should be covered with Termiflex).
- Start the HomeGuard® Sheet within 20 mm of the upper edge of the new concrete. Adhere all joints and ensure that the HomeGuard® sheet remains continuous along the footing and for 300 mm horizontally under the new concrete.
- Calculate the required width of TMB or PB considering the minimums required.

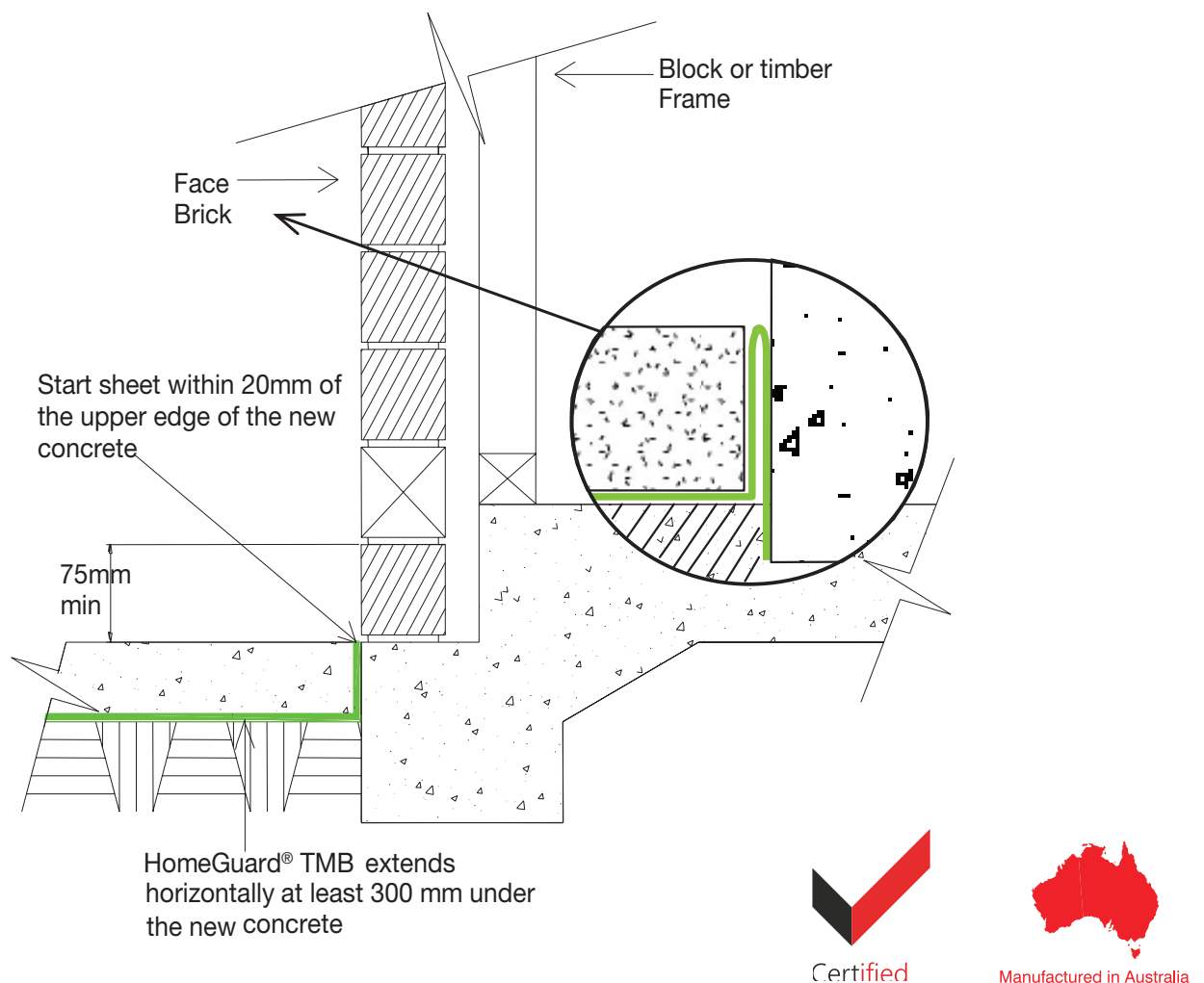

Please always refer to the HomeGuard® Installation Manual for further information