

## Suspended floors - Various

- For suspended floors and beams HomeGuard® DPC or HomeGuard® PB should be cut to allow 40 mm overhang.
- If stumps have a pin or thread in the centre, make a hole slightly smaller than the pin in the sheet and force it down over the pin.
- Do not nail the sheet to the stump, use Termiflex® or an approved adhesive.
- The HomeGuard® sheet can be installed under a traditional aluminium or tin termite shield if necessary.
- HomeGuard® sheet must have an overhang of 40 mm on all sides of piers.

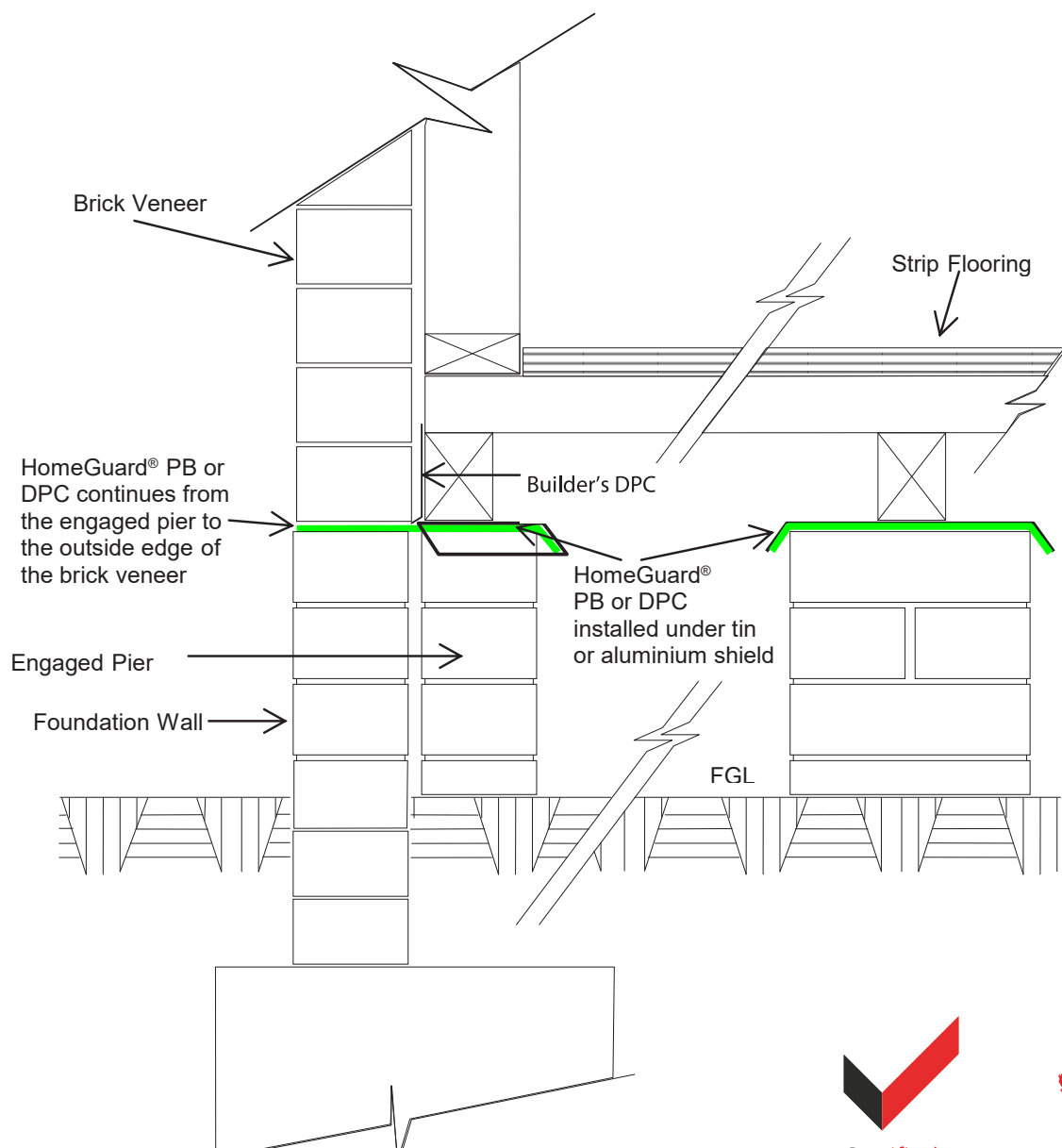

621016



Please always refer to the HomeGuard® Installation Manual for further information