

## Perimeter cavity render detail

Only Rendered Bricks require a strike joint. Bagged Bricks do not require a Strike Joint.

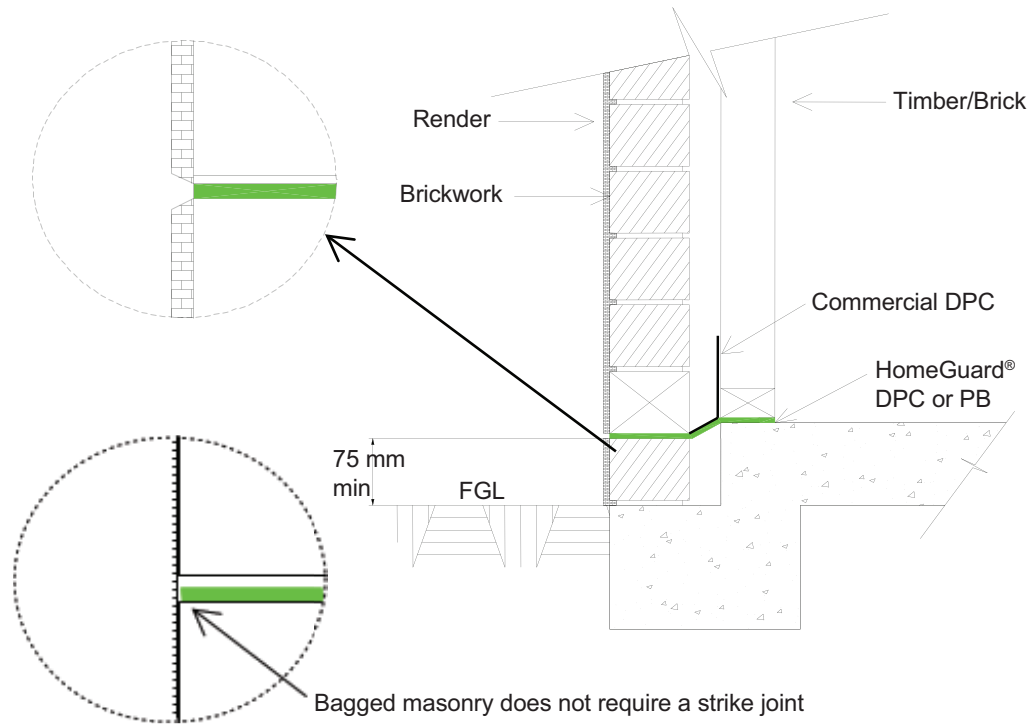

- Sheet materials shall be sheeted to the outside wall face and the sheeting shall be continuously visible at the exterior.
- When an external wall is rendered, the sheet shall be finished flush with the outside face of the render, this requires the trade to rake back the render to expose the HomeGuard®.
- Ensure you communicate these details with your builder to ensure compliance is met.

1021037



Certified



Manufactured in Australia

Stay up to date with our latest news and products, Click or scan to subscribe to FMC GSS news.

